

# SWIMMING POOL PRODUCTS

**PERMA-CAST**

**NEW  
PAGE 5**

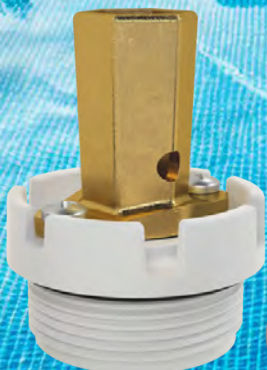





## SWIMMING POOL PRODUCTS ...SMART PRODUCTS FOR SMART BUILDERS



### Limited Warranty:

Perma-Cast, LLC warrants all new swimming products against defects in material and workmanship for a period of one year from the date of original purchase. Perma-Cast will replace or repair, at its option, any product established to be so defective with a product of like size configuration and function. This warranty is limited to replacement of product. Claims of labor costs and other charges resulting from the use of Perma-Cast Products are not covered by this warranty.

This warranty only applies to products that are not altered or damaged or used beyond their intended use. This warranty is in lieu of all other warranties express or implied of merchantability or fitness for a particular purpose which would otherwise extend beyond the warranties specified herein. this warranty specifically excludes incidental or consequential damages of any kind.

This warranty is effective only for the benefit of the original purchaser.  
Contact our office at 719-544-9544 for warranty claim procedure.

For More Information: [HTTPS://WWW.PERMA-CAST-LLC.COM/](https://www.perma-cast-llc.com/)



# EXCLUSIVE PRODUCT LINES



PAGE 15-16



PAGE 17-18



PAGE 21



CONTENTS

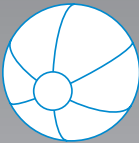

## Table of Contents

Anchor Sockets.....	3-6	Ladder Hinge.....	21
Anodes for Salt Water Pools.....	19-20	Escutcheons .....	9
Big Boy Socket.....	6	PoolBond Water Bonding Fitting.....	15-18
Channel Sets .....	7	Replacement Wedges .....	8
Cup Anchors.....	11	Safety Rope Hooks/Rope Clamps.....	12
Deck Flanges.....	10	Safety Rope Eyes.....	13-14
		Specialty Products.....	22

# ANATOMY OF AN ANCHOR SOCKET

## ANCHOR SOCKETS

Swimming Pool Rail Anchor Sockets are not overly complicated; however, they have many functions in a proper pool rail installation.

- The anchor must hold the pool rail securely in the proper location
- The anchor must allow easy rail removal for service or seasonal storage
- The anchor must connect the rail properly to electrical ground (electrical bonding)
- Any splashed water must be drained away from the anchor to avoid corrosion
- The anchor must function for many years of reliable carefree service

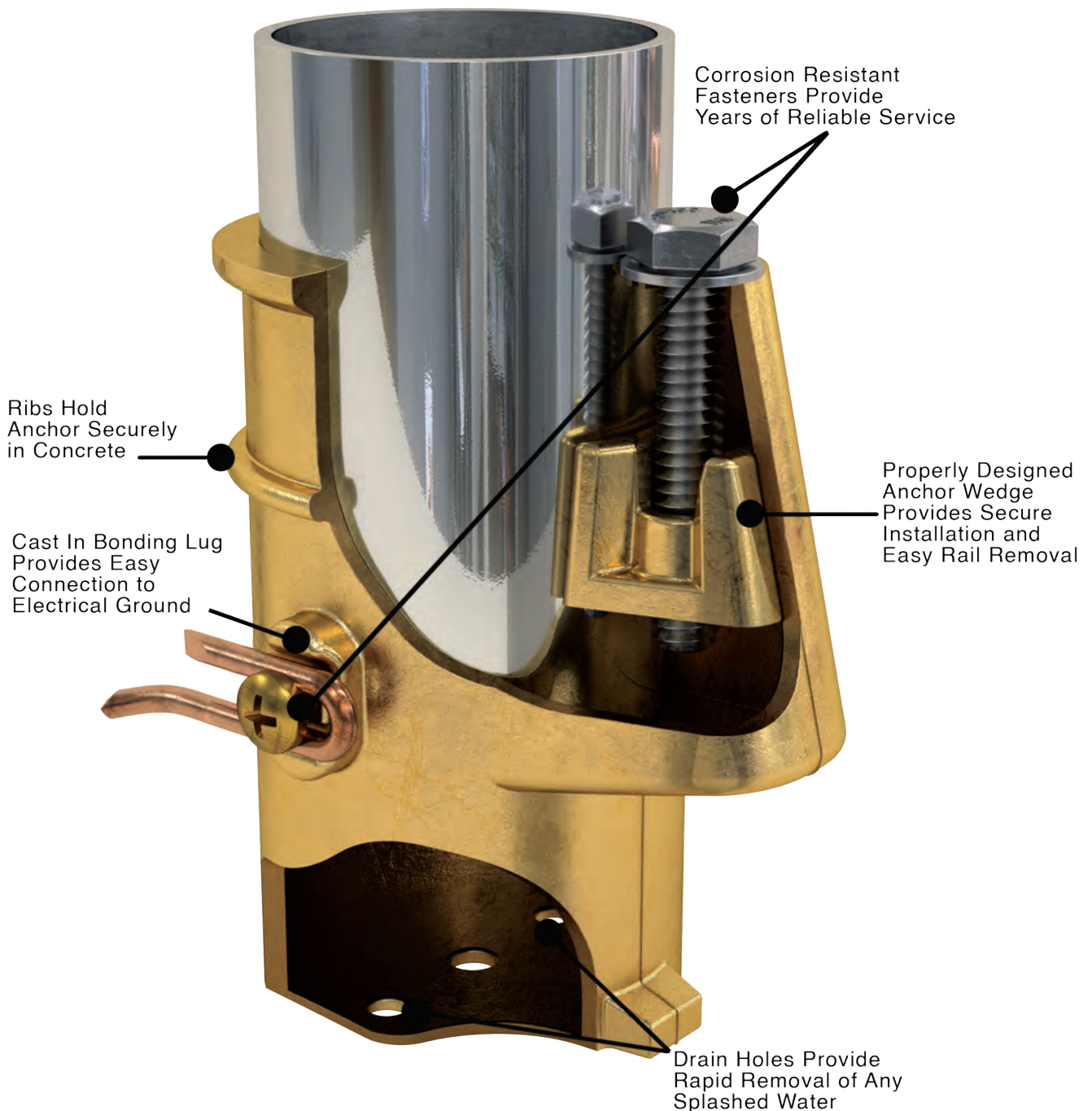

For More Information: [HTTPS://WWW.PERMA-CAST-LLC.COM/](https://www.perma-cast-llc.com/)



# PROPER ANCHOR INSTALLATION

## CHOOSING THE CORRECT ANCHOR SOCKET FOR THE JOB

- Not all anchor sockets are compatible with salt water sanitation systems
- Not all anchor sockets are intended for use in commercial installations
- Use the chart below to select the proper anchor for the job
- Anchor socket warranties are limited to product replacement and do not include labor or any other installation costs

Pool Type/Sanitation	Aluminum	Plastic	Bronze
Residential	●	●	●
Residential/Salt Water		●	●
Commercial Pools			●

Anchor Socket Warranty	Aluminum	Plastic	Bronze
Limited 1 Year Warranty	●		
Limited 10 Year Warranty		●	
Limited Lifetime Warranty			●



## DETERMINING THE CORRECT ANCHOR LOCATION AND PLACEMENT

- Anchor setback from pool wall
- Anchors must be level - anchor to anchor
- Anchors must be plumb
- Anchors must be installed on proper center distance
- Anchor drain holes must be open
- Anchor socket must be connected to electrical ground
- Top of anchor must be flush with concrete deck

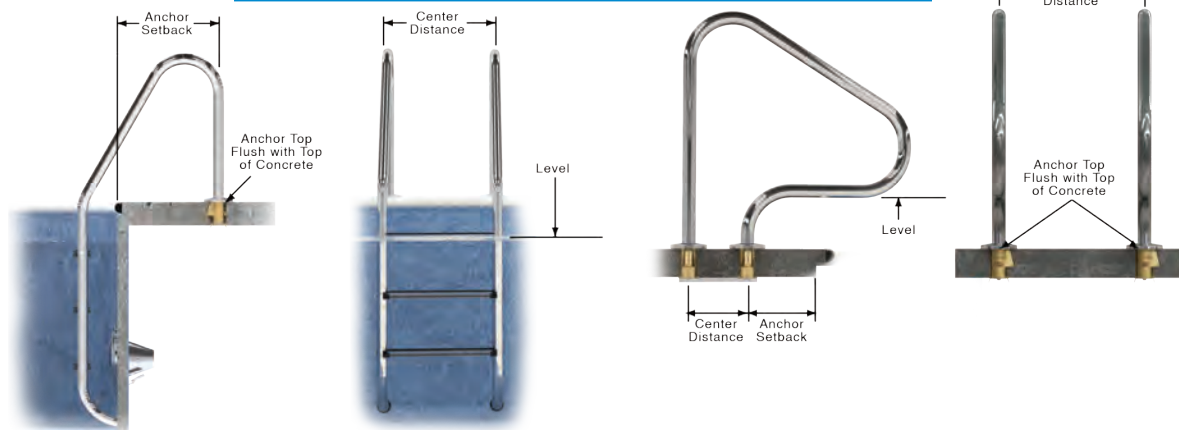

## CHECKING FOR PROPER DRAINAGE

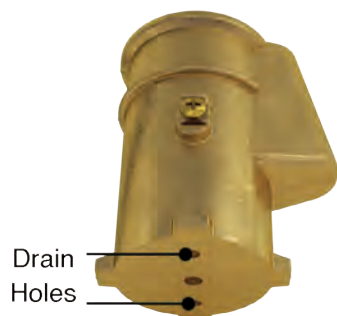

It is critical that anchor socket drain holes are always open and free of debris. This should not only be checked during installation, but annually to assure proper drainage. Improper drainage can cause corrosion which could lead to damage to pool deck and equipment.





# ANCHOR SOCKET PRODUCT LINE

## UMBRELLA SOCKET

### AVAILABLE IN THREE CONFIGURATIONS

- Includes anchor socket, flip insert and retro insert
- Socket sleeve is threaded and tapered for tight fit
- Anchor sockets and inserts are available in gray and white ABS plastic



**COMPLETE ASSEMBLY**  
Gray PS-7015UG  
White PS-7015UW



**REPLACEMENT  
FLIP INSERT**  
Gray PI-7015FG  
White PI-7015FW



**RETRO INSERT**  
Gray PI-7015RG  
White PI-7015RW

## STANDARD POOL RAIL SIZES

**1.9" DIAMETER RAIL**



MOST POOL  
RAILS ARE  
THIS SIZE

**1.5" DIAMETER RAIL**



COMMERCIAL RAIL  
SPECIFIED FOR ADA  
(AMERICANS WITH DISABILITY ACT)

**1.625" DIAMETER RAIL**



CUSTOM  
RAIL SIZE

### ALUMINUM

1 YEAR LIMITED WARRANTY

## ANCHORS FOR 1.9" RAILS

### PLASTIC

10 YEAR LIMITED WARRANTY



PS-4019-C  
HANOVER CLONE



PS-4019-A  
ORIGINAL  
PERMA-SOCKET



PS-3019-A  
ORIGINAL  
PERMA-SOCKET



PS-4019-P

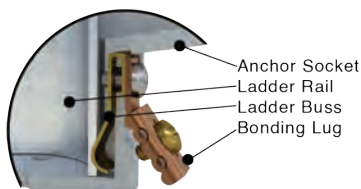

**RAIL BONDING  
SYSTEM**



# ANCHOR SOCKET BRONZE

Lifetime limited Warranty



ANCHORS FOR SPECIALLY SIZED RAILS

## BIG BOY PAVER DECK SOCKET

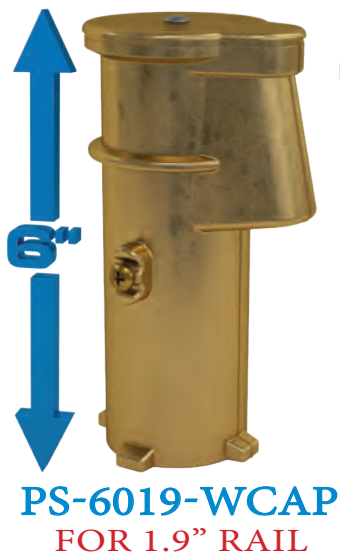
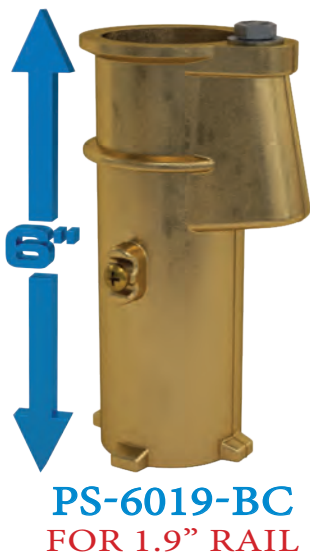

CAN ALSO BE USED FOR  
POOL TOYS:

BASKETBALL HOOPS  
VOLLEYBALL SETS

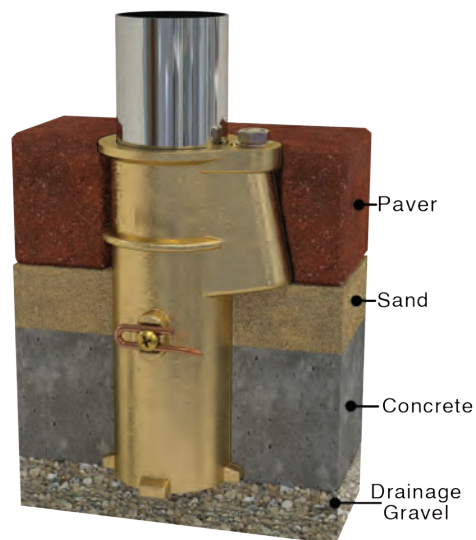



# PRE-MOUNTED CHANNEL SETS

THIS BUILDING AID MAKES ANCHOR INSTALLATION A SNAP.  
LOCATE THE CHANNEL AND LEVEL ANCHORS IN BOTH DIRECTIONS.  
ANCHORS WILL AUTOMATICALLY BE PLUMB WITH CORRECT CENTER DISTANCE.

## AVAILABLE IN 2 CENTER DISTANCES

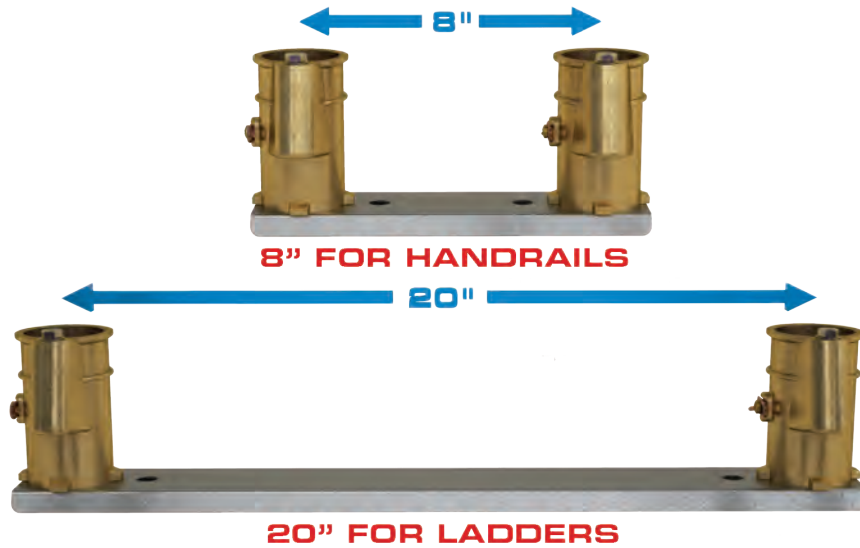

CHANNEL BRACKET IS FABRICATED FROM GALVANIZED STEEL  
USE THE CHART BELOW TO ORDER THE CORRECT PART NUMBER

## CHANNEL SETS AVAILABLE FOR THESE ANCHORS

Channel Part No.	Socket Part No.	Center Distance
<b>Aluminum Anchor</b>		
PC-3008-A	PS-3019-A	8 Inches
PC-3020-A	PS-3019-A	20 Inches
PC-4008-A	PS-4019-A	8 Inches
PC-4020-A	PS-4019-A	20 Inches
PC-4008-AC	PS-4019-AC	8 Inches
PC-4020-AC	PS-4019-AC	20 Inches
<b>Bronze Anchor</b>		
PC-3008-B	PS-3019-B	8 Inches
PC-3020-B	PS-3019-B	20 Inches
PC-4008-B	PS-4019-B	8 Inches
PC-4020-B	PS-4019-B	20 Inches
PC-4008-BC	PS-4019-BC	8 Inches
PC-4020-BC	PS-4019-BC	20 Inches
PC-6008-BC	PS-6019-BC	8 Inches
PC-6020-BC	PS-6019-BC	20 Inches
<b>Plastic Anchor</b>		
PC-4008-P	PS-4019-P	8 Inches
PC-4020-P	PS-4019-P	20 Inches

Diagram illustrating the channel sets available for these anchors, showing the channel bracket (PC) and the corresponding socket (PS) for different anchor types and center distances.

Channel sets are available for the following anchor types and center distances:

- Aluminum Anchor:** PS-3019-A (8" and 20" center distances), PS-4019-A (8" and 20" center distances), PS-4019-AC (8" and 20" center distances).
- Bronze Anchor:** PS-3019-B (8" and 20" center distances), PS-4019-B (8" and 20" center distances), PS-4019-BC (8" and 20" center distances), PS-6019-BC (8" and 20" center distances).
- Plastic Anchor:** PS-4019-P (8" and 20" center distances).

Channel sets are available for the following anchor types and center distances:

- Aluminum Anchor:** PS-3019-A (8" and 20" center distances), PS-4019-A (8" and 20" center distances), PS-4019-AC (8" and 20" center distances).
- Bronze Anchor:** PS-3019-B (8" and 20" center distances), PS-4019-B (8" and 20" center distances), PS-4019-BC (8" and 20" center distances), PS-6019-BC (8" and 20" center distances).
- Plastic Anchor:** PS-4019-P (8" and 20" center distances).

For More Information: [HTTPS://WWW.PERMA-CAST-LLC.COM/](https://www.perma-cast-llc.com/)



# WEDGE ASSEMBLIES

## PW



FOR USE WITH ANCHOR:

- PS-3019-A
- PS-3019-B
- PS-4019-A
- PS-4019-B
- PS-4015-B

## PW-4C



FOR USE WITH ANCHOR:

- PS-4019-C
- PS-4019-BC

## PW-WB



FOR USE WITH ANCHOR:

- PS-3019-WB

\*Also Sub for Hanover #35\*

## PW-6C



FOR USE WITH ANCHOR:

- PS-6019-BC

## PW-3C



FOR USE WITH ANCHOR:

- HANOVER #30

## PW-P



FOR USE WITH ANCHOR:

- PS-4019-P

## OTHER WEDGES



PW-PARAGON



PW-HAYWARD



PW-16



PW-FROST



PW-LINDBERG



PW-OLD

Part No.	Length (L)	Height (H)	Depth (D)	Bolt Length
PW	1.03"	.6"	.925"	1-1/2"
PW-4C	1.18"	1"	1.1"	1-3/4"
PW-6C	1.18"	1"	1.1"	2"
PW-P	1.05"	1.1"	1.09"	2"
PW-WB	.825"	.825"	1.12"	1-3/4"
PW-16	1.2"	.625"	1.08"	1-3/4"
PW-3C	.76"	.625"	.935"	1-1/2"
PW-PARAGON	1.57"	.75"	1"	2"
PW-ACTIVE	1.05"	.5"	1"	1-1/4"
PW-FROST	1.125"	.45"	1.25"	1-1/2"
PW-HAYWARD	1.07"	.975"	1.34"	2"
PW-LINDBERG	1.22"	.935"	1.28"	1-3/4"
PW-OLD	1.45"	1.1"	1.38"	2-1/4"

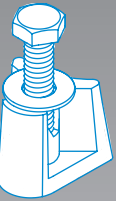
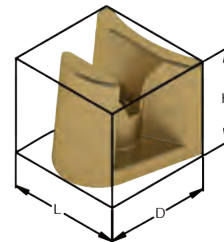

# ESCUTCHEONS

HIDE YOUR ANCHOR SOCKETS

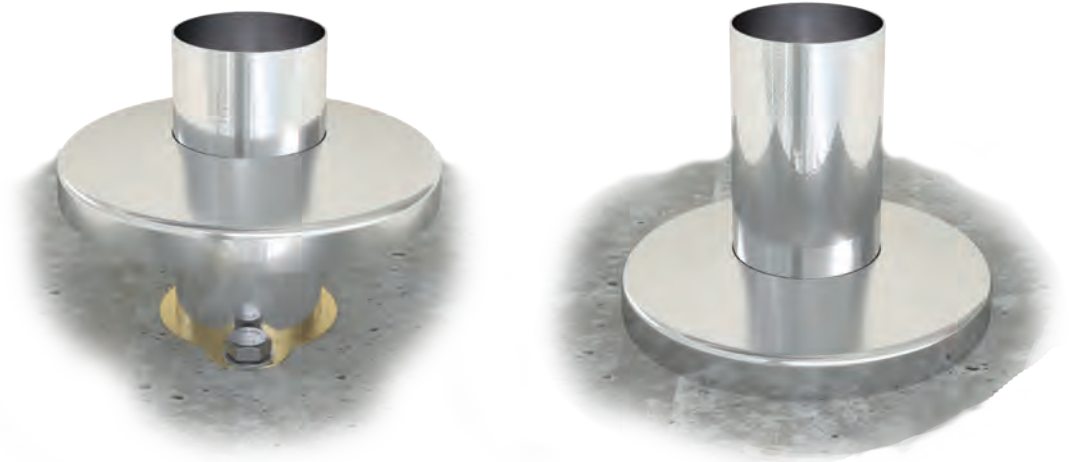

## 1.5" TUBING

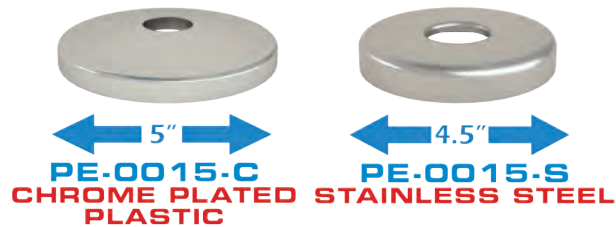

## 1.9" TUBING

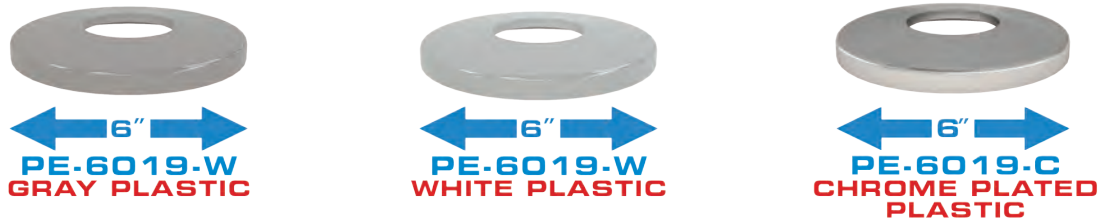

## 1.9" TUBING

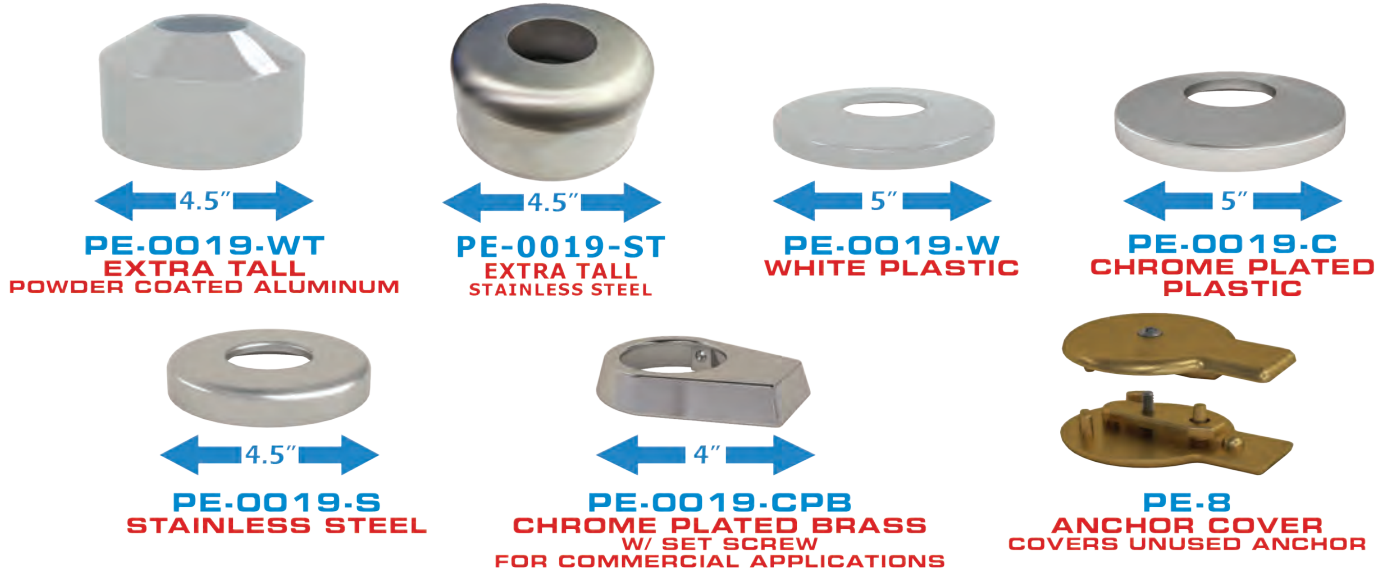

For More Information: [HTTPS://WWW.PERMA-CAST-LLC.COM/](https://www.perma-cast-llc.com/)



# FLANGES

## ANATOMY OF A DECK FLANGE

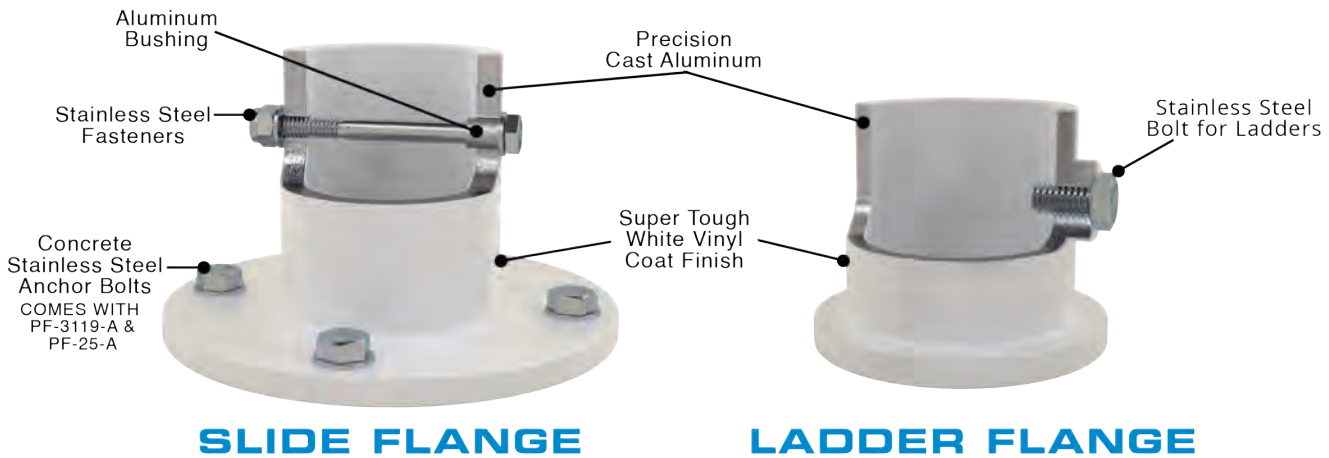

**SURFACE MOUNT FOR LADDERS & SLIDES**  
**NOT APPROVED FOR HANDRAILS**

## LADDER FLANGES

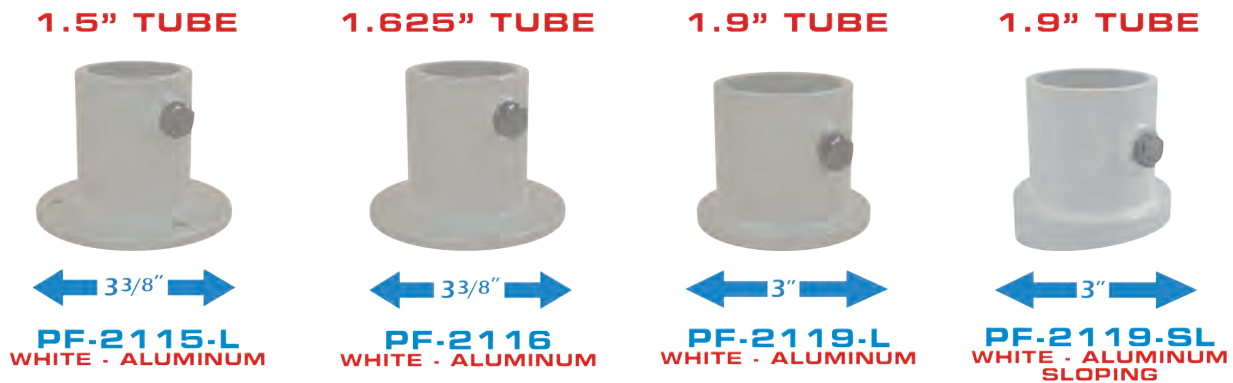

## SLIDE FLANGES

1.9" TUBE



\*INCLUDES CONCRETE ANCHOR PACK

FLANGES

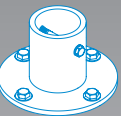

# COMMERCIAL CUP ANCHORS

NOT RECOMMENDED FOR SALT POOLS

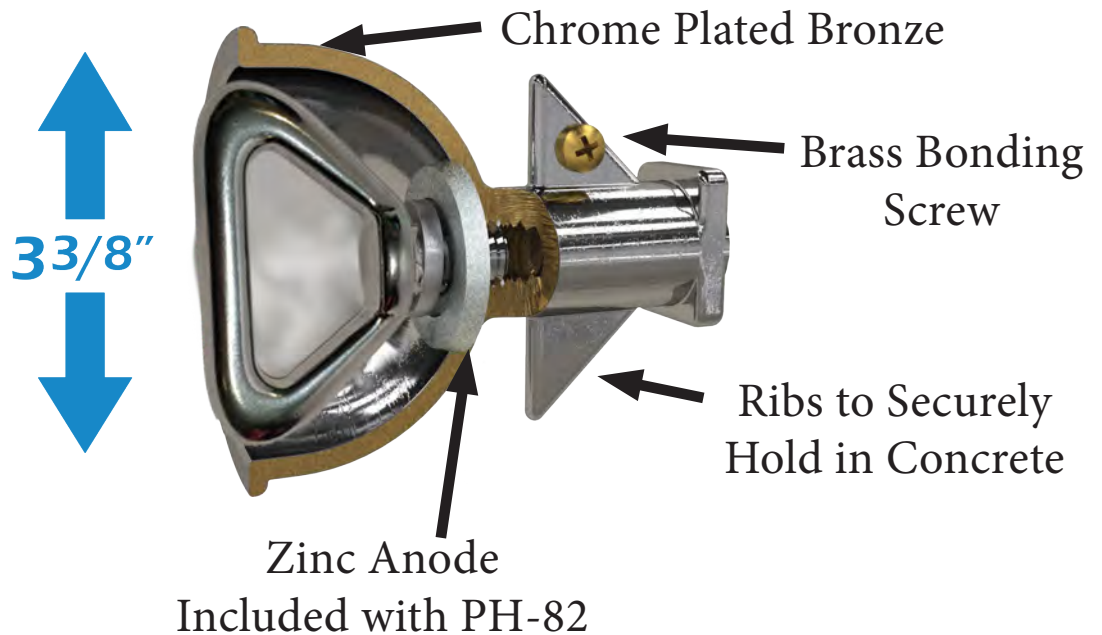

PH-82



WITH REMOVABLE  
EYE BOLT

PH-82-EYE



REPLACEMENT EYE  
 $1/2"$ -13 THREADS

PH-82-B



WITH  
CROSS BAR



# ROPE HOOKS/CLAMPS

## CLEAT TYPE

Clean Finish Installation  
Holds Rope Securely



## LOOP TYPE

Easy Installation  
Holds Rope Securely



### CLEAT TYPE



**PH-52**  
3/8" - 1/2" ROPE



**PH-53**  
3/4" ROPE

### LOOP TYPE



**PH-52H**  
3/8" - 1/2" ROPE



**PH-51H**  
3/4" ROPE

### STANDARD S-HOOK



**PH-55**  
1/4" - 1/2" ROPE



**PH-56**  
3/4" ROPE

## ROPE CLAMPS CHROME PLATED BRONZE

**PH-57**



1/4-3/8" ROPE

**PH-58**



1/2" ROPE

**PH-59**



3/4" ROPE

FOR MORE INFORMATION GO TO: [WWW.PERMACASTONLINE.COM](http://WWW.PERMACASTONLINE.COM)

ROPE HOOKS

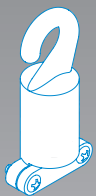

# ROPE EYES

## CHROME PLATED BRONZE FOR CONCRETE POOLS

### PI-73

#### ARROW HEAD ROPE EYE

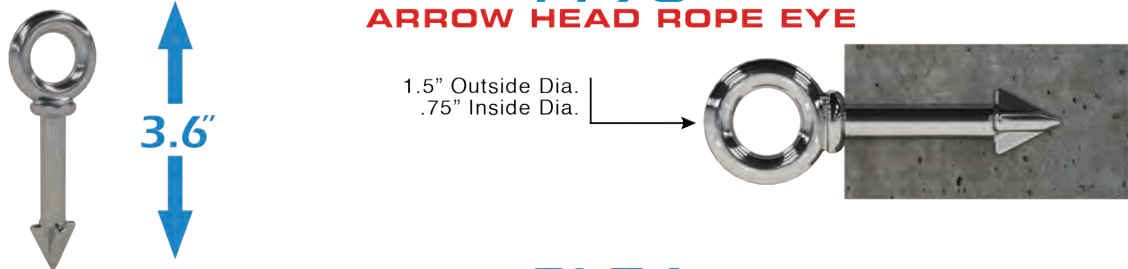

### PI-74

#### 1/2" ROPE EYE WITH LEAD ANCHOR

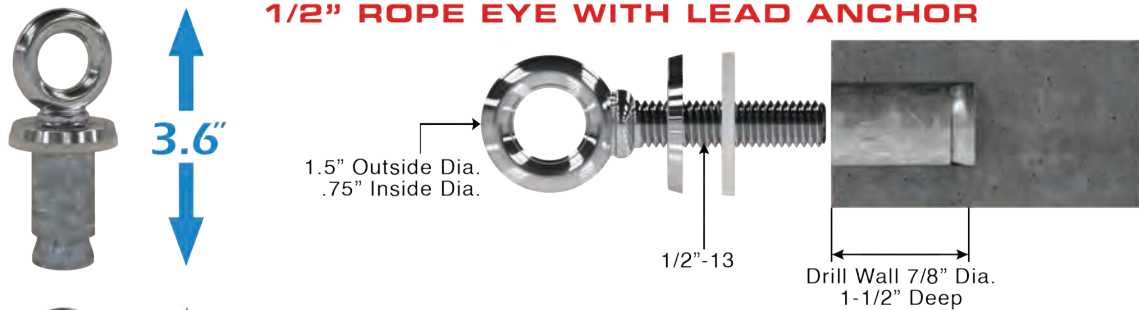

### PI-74S

#### 1/2" ROPE EYE WITH LAG SHIELD

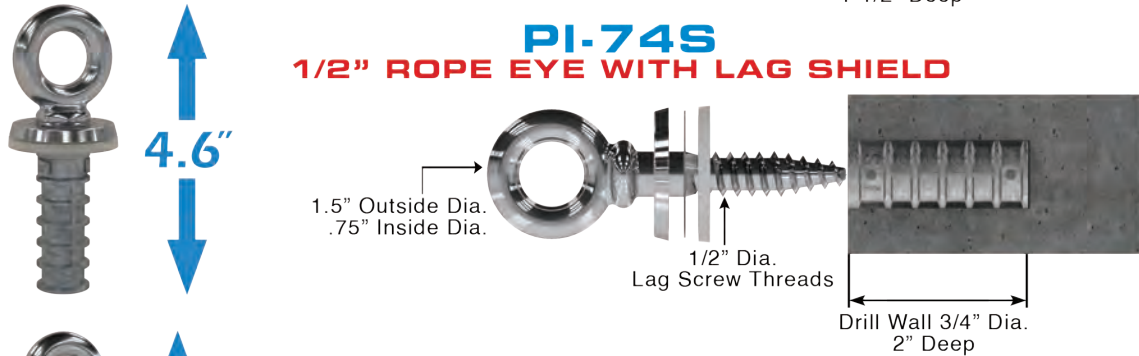

### PI-74B

#### COMMERCIAL RACING LANE ANCHOR

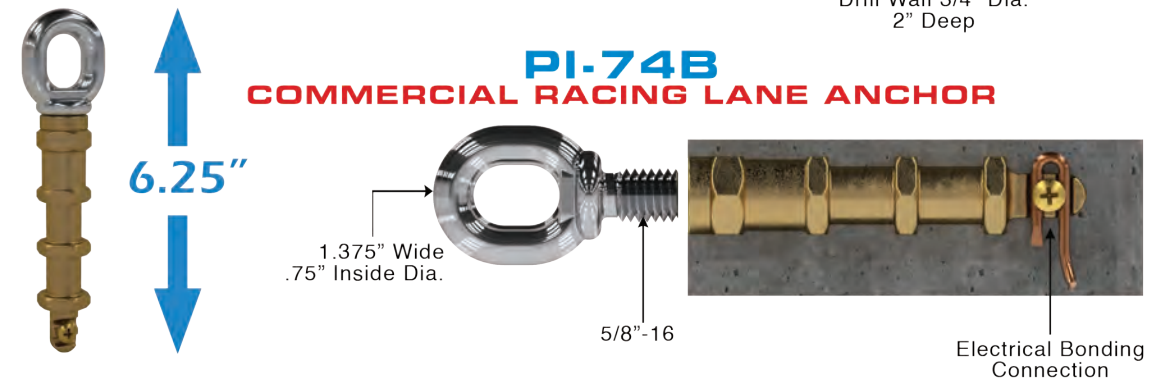

### PI-77

#### STANDARD EYE BOLT

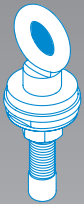
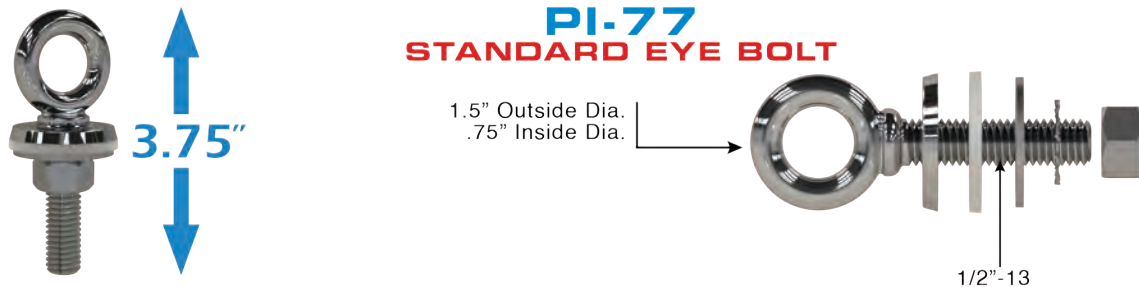



# ROPE EYES

## CHROME PLATED BRONZE FOR VINYL POOLS COPING MOUNT

**PI-70**  
OVAL ROPE EYE



**PI-7X**  
COPING EYE ANCHOR



**PI-7F**  
FLAT COPING EYE

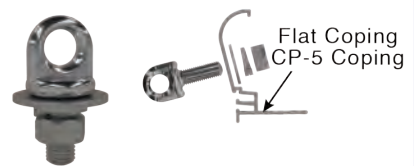

## WALL MOUNT VINYL LINER POOLS

**PI-2000**

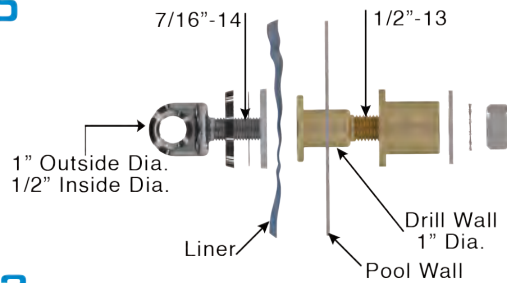

**PI-72B**



**PI-72B.2**

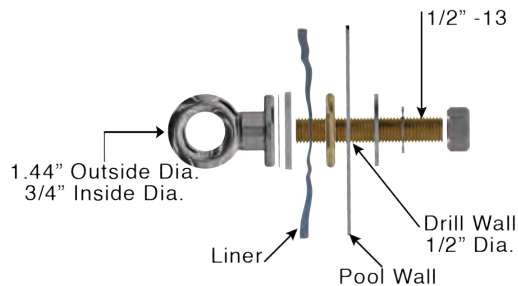

**PI-72**

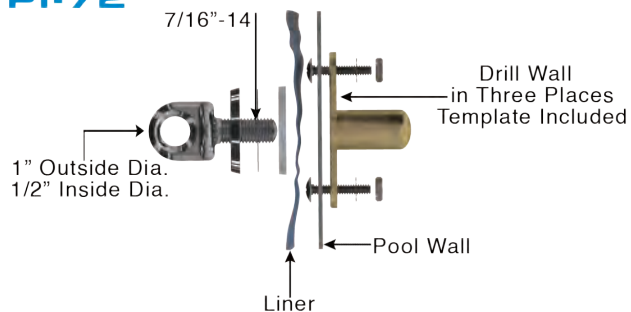

**PI-76B**

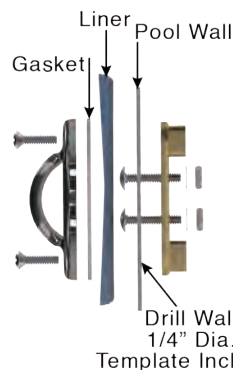

**PI-76**



**Stainless Steel Fasteners  
Are Standard**



# POOLBOND FITTINGS

## WHAT IS POOL WATER BONDING

When water comes in contact with an electrical source such as a defective submerged luminaire or a pump motor, persons in the pool can be subject to an electric shock. The (NEC) National Electrical Code requires protection from this shock hazard by maintaining an effective connection between the water itself and the pool's equipotential bonding grid.

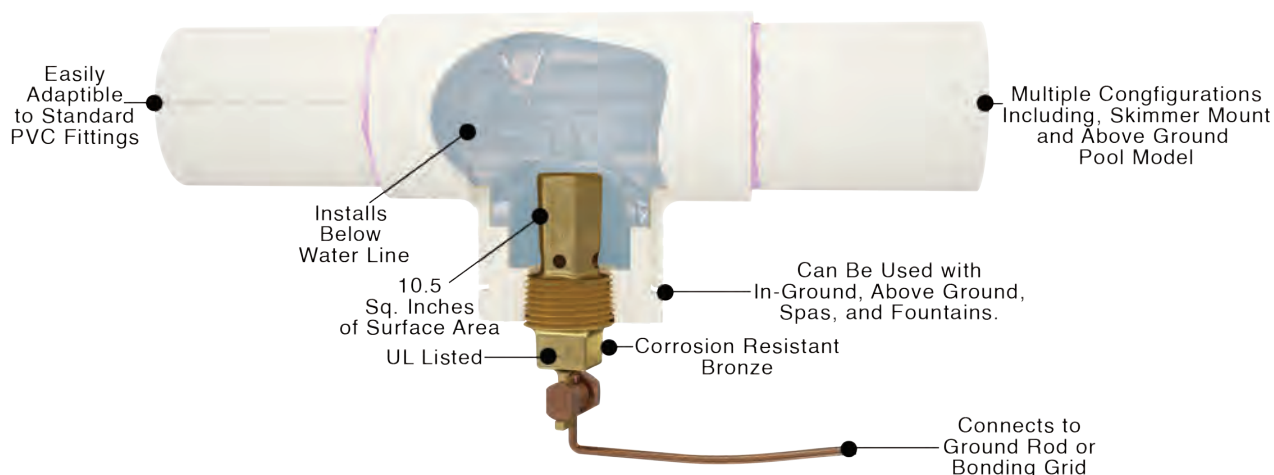

## AND WHY DO YOU NEED IT

The requirements issued by the National Electric Code (NEC) that a corrosion-resistant conductive structure with a surface area of at least 9 square inches must be installed in contact with the water and connected to the equipotential bonding grid. This ensures that the pool water and the equipotential bonding grid have the same electrical potential.





# POOLBOND FITTINGS

## PB-2008

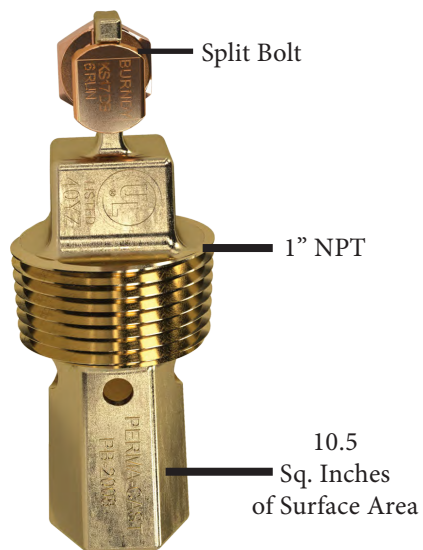

## WHERE TO INSTALL IN-GROUND POOLS      ABOVE GROUND POOLS



NEAR  
POOL EQUIPMENT



AT POOL PUMP



AT RETURN FITTING



ABOVE GROUND  
POOL SKIMMER

## PLUMBING KITS

1.5" PLUMBING KIT



2" PLUMBING KIT



ABOVE GROUND  
PLUMBING KIT



08KIT-15

08KIT-20

08KIT-AG

PB-2008 NOT INCLUDED WITH KITS

POOLBOND



# SKIMMER MOUNT FITTINGS

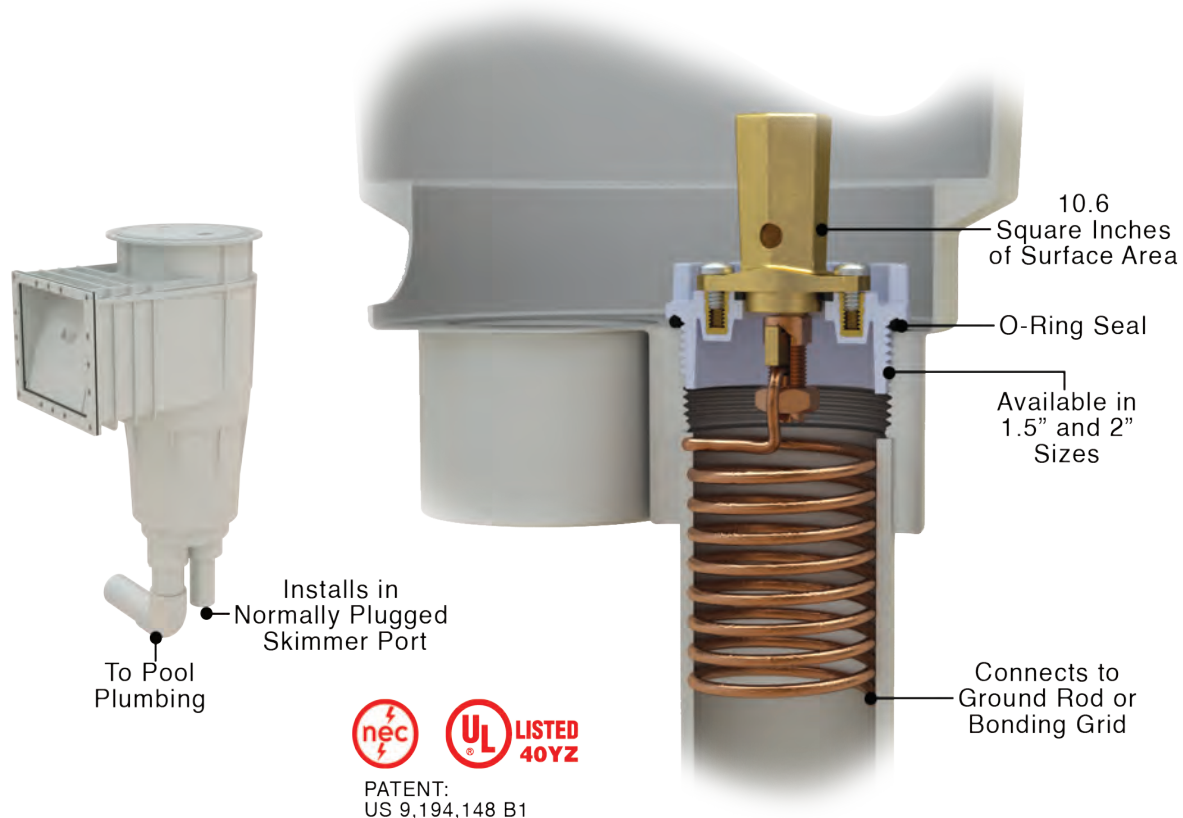

**PB-SK-15**  
1.5" FITTING



**PB-SK-20**  
2" FITTING





# ABOVE GROUND FITTINGS

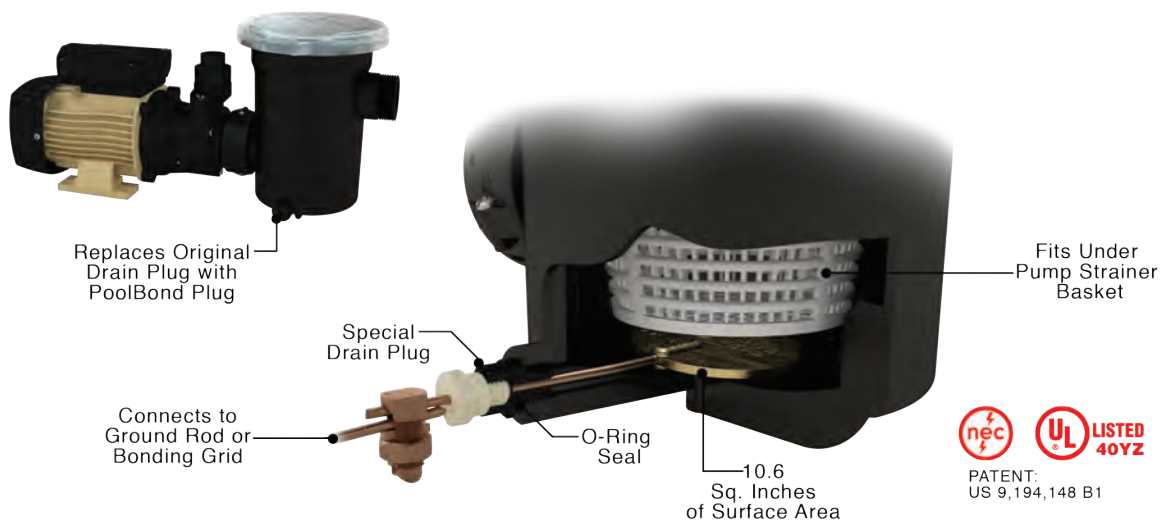

## PB-AG

ABOVE GROUND FITTING

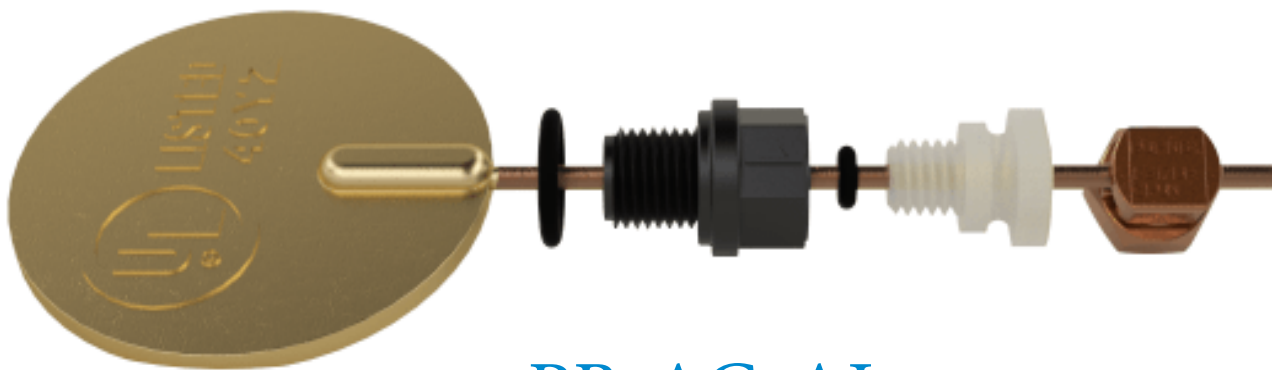

## PB-AG-AL

ABOVE GROUND FITTING  
REPAIR KIT



POOLBOND



# TECHNODE SALT POOL ANODES

DEVELOPED FROM RESEARCH AT GEORGIA TECH

## HOW ANODES WORK

When metal components are exposed to salt water they generally tend to corrode at a relatively rapid rate. By connecting a zinc anode to these metal components, the anode will corrode and pass a small electrical current to the different metal (the cathode). The passing of this electrical current will drastically reduce the rate of corrosion of the cathode. As a result, effectively used anodes in a salt pool can reduce the rate at which critical metal components tend to corrode.

## DIRECT CONTACT ANODES

### TN-LD

#### LADDER ANODE

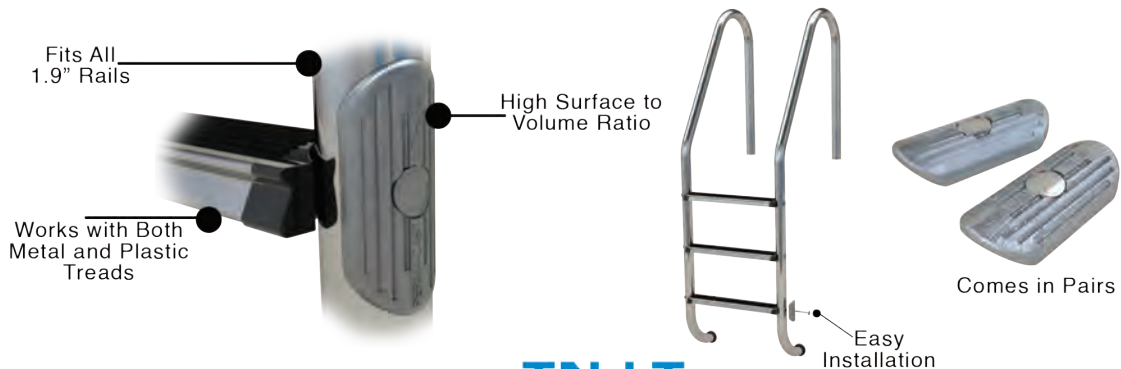

### TN-LT

#### LIGHT ANODE



### TN-SK

#### UTILITY ANODE

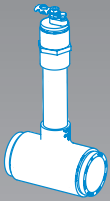
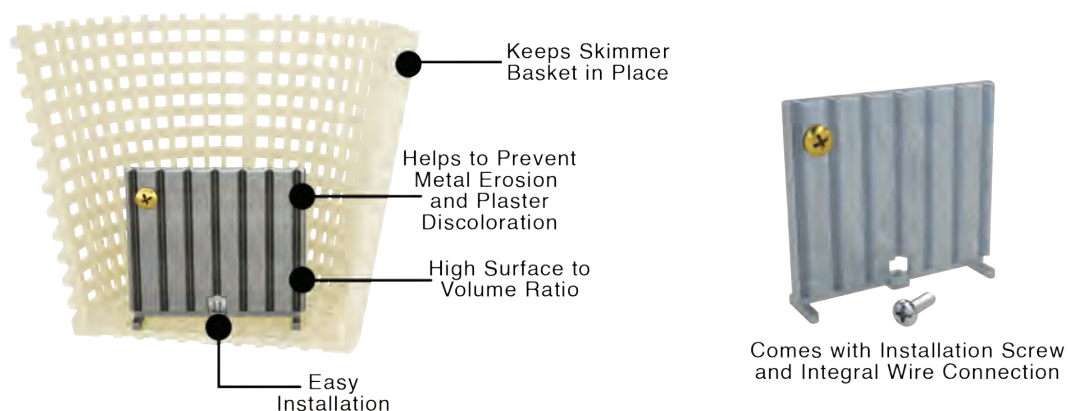

# INLINE ANODES

Inline Anodes have become a “must install” component in salt water pools for many top builders. These builders believe that Inline Anodes solve the complex corrosion problems present when salt system sanitation is used. It should be noted that no comprehensive field study has been made to verify the effectiveness of the Inline Anode.

## How Inline Anodes Work

The Inline Anode is a new concept in anodic protection. The zinc anode is attached to the pool bonding grid which connects all metal components tied to the grid. This concept was patented by Pool Tool Company in 2010 under U.S. Patent 7,688,116 B1.

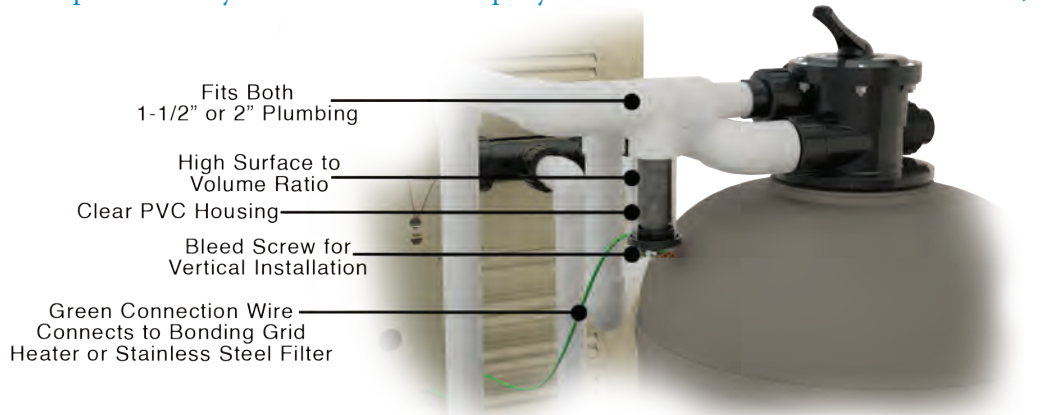

**TN-IL**



**TN-IL-20**



Kits Includes:  
Clear Anode Housing  
Zinc Anode  
Technode Cap  
PVC Fittings  
Wire Lug  
Anode Connection Wire  
Bleed Screw  
Stainless Steel Fasteners  
Weather Proof Installation Sticker

## REPLACEMENT INLINE ANODE ZINC

**TN-100**



Replacement for  
TN-IL

**TN-200**



Replacement for  
TN-IL-20

## WHY USE TECHNODE

Anodes are designed to corrode and protect other metal components in the pool. Greater surface area means more protection for the pool components. The anodes mass (weight) determines the amount of protection an anode can supply until it has completely corroded. A sheet of zinc foil with a large surface area and small mass will provide a lot of protection over a short period of time as it will quickly corrode away. A zinc ball with a large mass and relatively small surface area will provide a small amount of component protection over a long period of time. TechNode Anodes are designed to provide maximum protection yet have reasonably long expected anode life. This combination of anode mass and high surface area makes TechNode the most efficient anode in the pool industry. Compare TechNode's specifications with the competition.

Part Number	Description	Anode Surface Sq. Inches	Anode Weight Pounds	Plumbing Pipe Size	Vented* Assembly
TN-SK	Skimmer Weight/Utility Anode	23	0.32	N/A	N/A
TN-LT	Protects Underwater Light/Niche	11	0.13	N/A	N/A
TN-LD	Protects Ladders - Sold in Pairs	27	0.65	N/A	N/A
TN-IL	Inline Anode Clear PVC - 1" Diameter	24	0.5	1-1/2 & 2"	Yes
TN-IL-20	Inline Anode Clear PVC - 2" Diameter	54	1.4	1-1/2 & 2"	Yes

Vented\* - Anode Assembly Vented for Vertical Installation

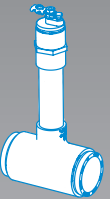



# LADDER - JOHNNY HINGE

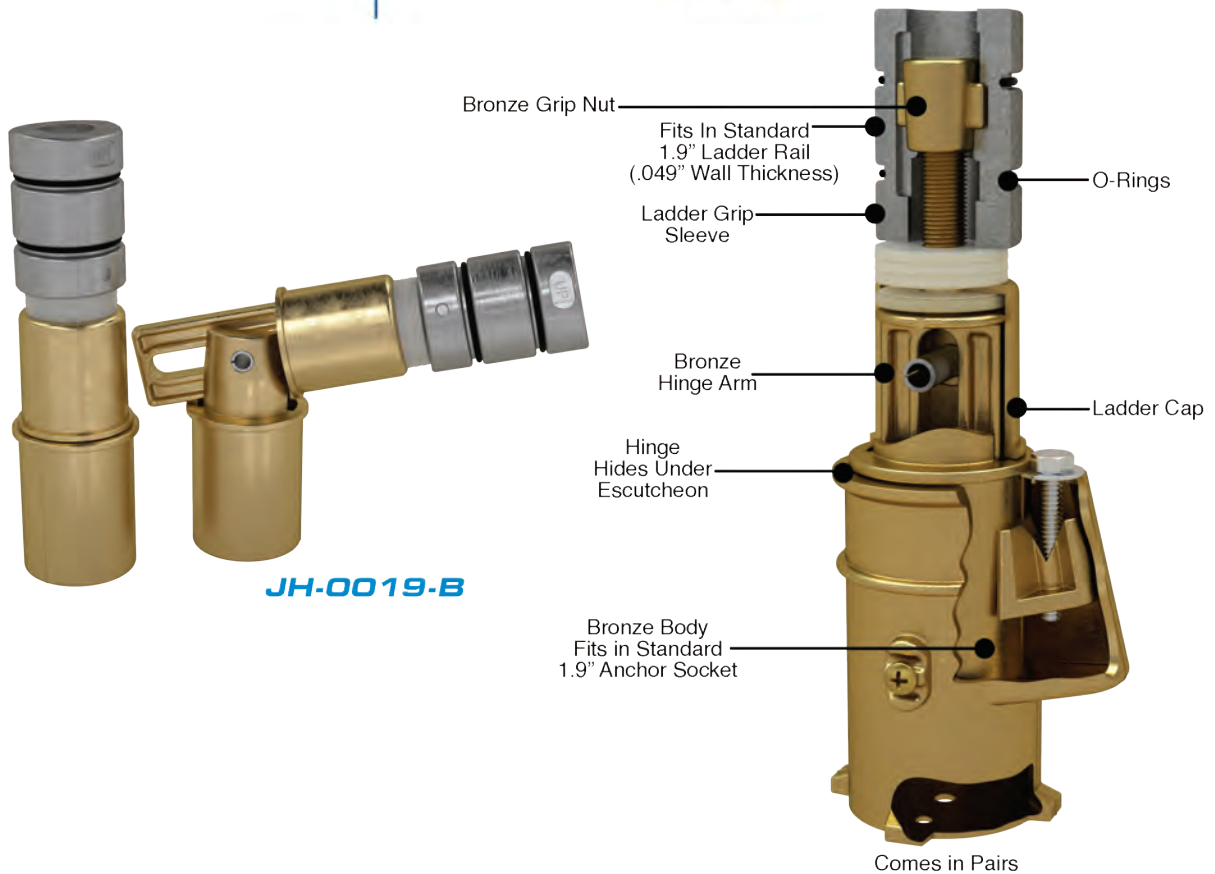

## **HINGING A POOL LADDER BECOMES CHILDS PLAY**

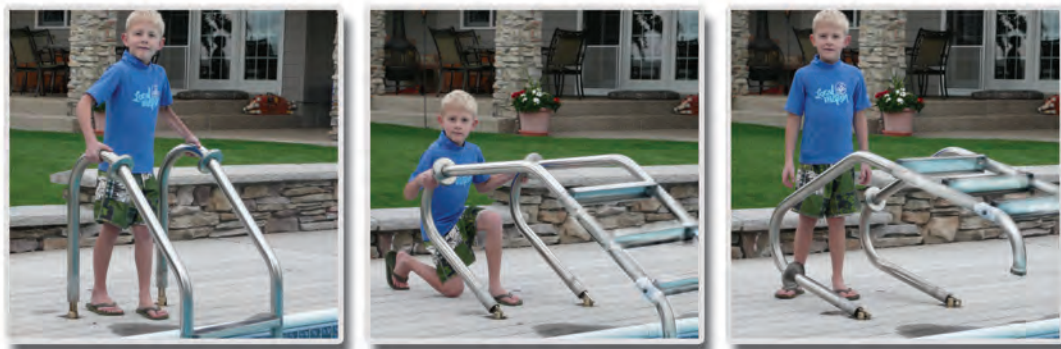

# SPECIALTY PRODUCTS

## HYDROSTATIC RELIEF VALVES

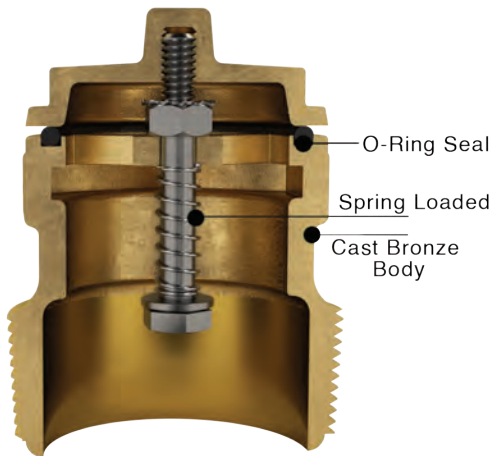

**PV-15**  
FOR 1.5" PIPE



**PV-20**  
FOR 2" PIPE

## RAIL REMOVAL TOOL

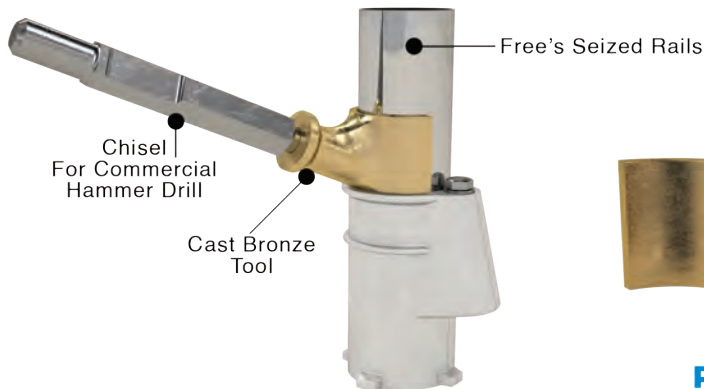

**RRT**



**RRT-CHISEL**

## WATER STOPS



**WS-15**



**WS-20**

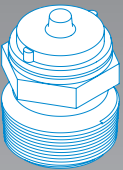



# SWIMMING POOL PRODUCTS

## FITTINGS THAT LAST...

Perma-Cast, LLC  
1871 Aspen Circle  
Pueblo, Colorado 81006  
SALES@PERMA-CAST-LLC.COM  
[HTTPS://WWW.PERMA-CAST-LLC.COM/](https://www.perma-cast-llc.com/)  
PH: 719-544-9544